

DINOR

INSTALLATION INSTRUCTIONS | AUGUST 2024

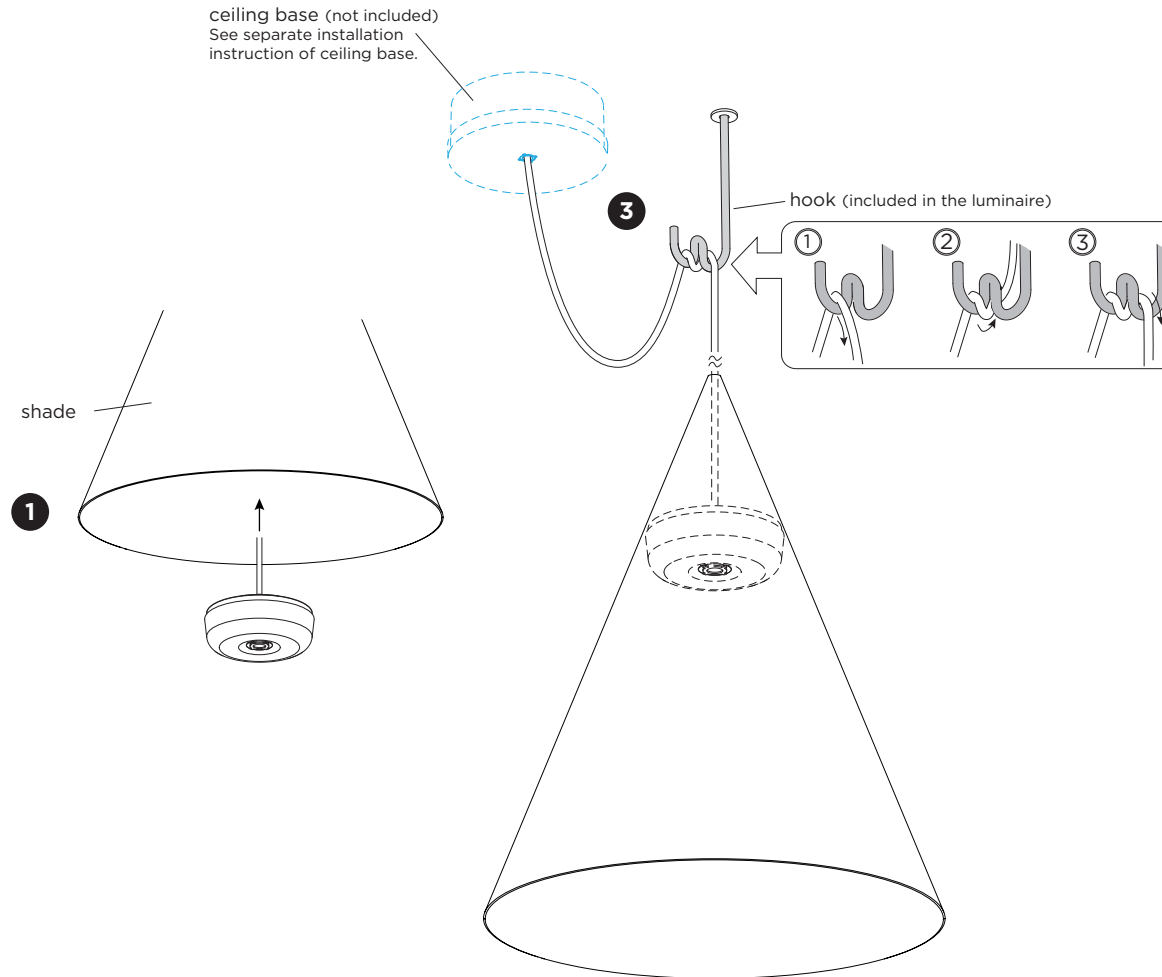

DIMENSIONS

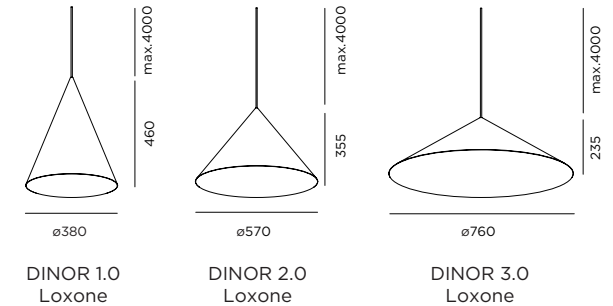

MOUNTING INSTRUCTION

- 1 Pass the cable of the LED module through the top of the shade.

POWER CONNECTION

- 2 Connect the wires to the connectors.
Input voltage 20-28V.



- 3 Optionally use the hook to support the cable.

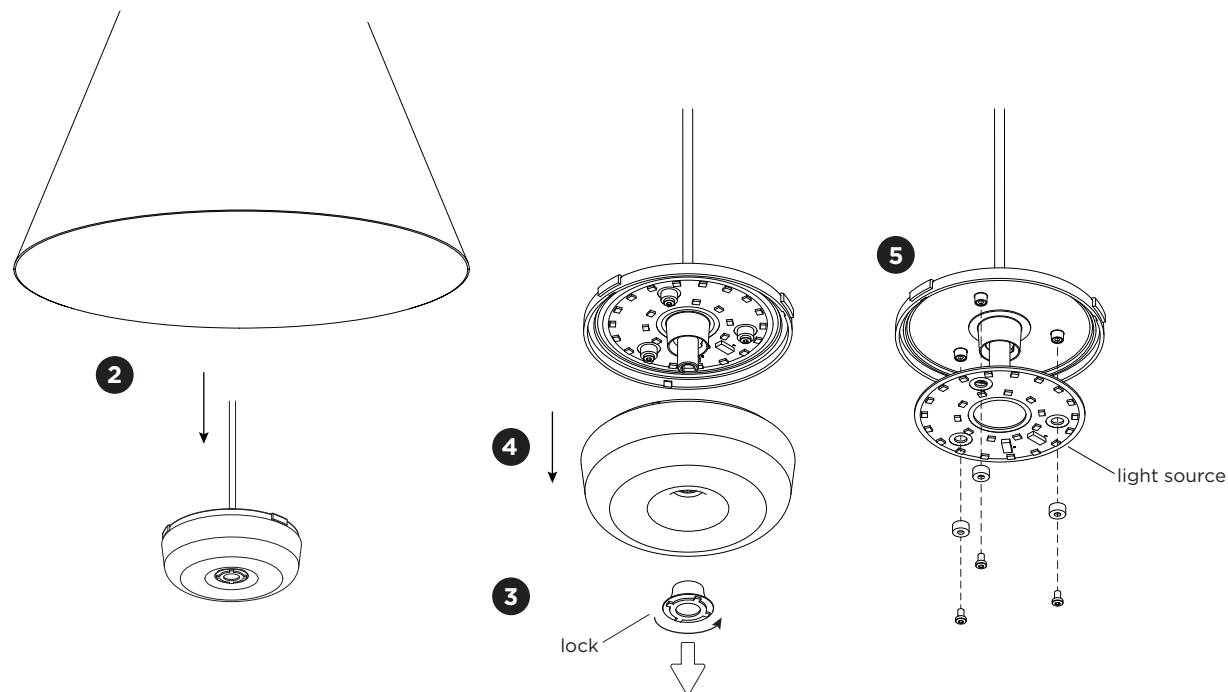

DISMANTLING AND RECYCLING INSTRUCTIONS

Light source

- 1 Loosen the wires from the power connection (see separate instructions manual from the ceiling base).
- 2 Dismount the LED module from the shade.
- 3 Remove the lock by turning it counter clockwise.
- 4 Remove the cover.
- 5 Loosen the screws and wires to remove the light source.

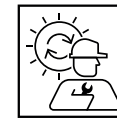

The light source is replaceable by Wever & Ducré or by a professional with explicit authorisation. For more information please contact your local Wever & Ducré customer service point.



This luminaire contains a light source with the energy class G.